

**Appartement B.4.4 4.5P**

Hall	11.11 m <sup>2</sup>
Cuisine/séjour	43.73 m <sup>2</sup>
Chambre 1	13.80 m <sup>2</sup>
Chambre 2	12.31 m <sup>2</sup>
Chambre 3	12.55 m <sup>2</sup>
Bain	6.28 m <sup>2</sup>
Douche	4.50 m <sup>2</sup>

<b>Total</b>	<b>104.28 m<sup>2</sup></b>
Loggia	7.43 m <sup>2</sup>

**Surface de vente nette** 109.34 m<sup>2</sup>

Mobilier illustratif, non fourni

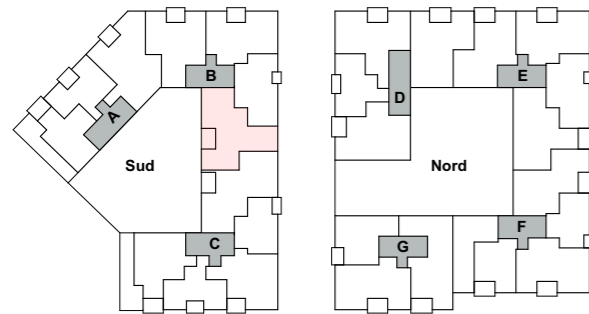
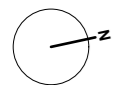

Etage +4

**598 - L'Esplanade**

Plan : B.4.4  
 Date : 08.03.2019  
 Modifications : 16.08.2019  
 Format : A3 / sans échelle

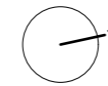

**B.4.4  
4.5P**

